

FLAT FACE/SCREW
VITE VALVOLA PIANA FLANGIATO
FLANGED FLAT FACE SCREW COUPLINGS
GEFLANSCHTE FLACHDICHTENDE SCHRAUBKUPPLUNGEN
COUPLEURS FACE PLANE A VISSER BRIDES

Caratteristiche tecniche

- Intercambiabilità: disegno esclusivo Dnp
- Occlusione: faccia piana
- Aggancio: a vite
- Materiale: acciaio
- Finitura: Zn-Fe (Cr III) e Zn-Ni
- Connessione: Flange SAE 6000
- Guarnizioni standard: NBR e PU
- Temperatura d'esercizio: -25 °C +100 °C
- Guarnizioni opzionali: FKM, EPDM o altro
- Pressioni di esercizio: 300-350 bar
- Connessione in pressione: consentita (lato maschio o lato femmina)
- Massima pressione residua: 300 bar

Nominal size				Max working pressure MPa	Rated flow l/min	Max flow rate l/min	Min burst pressure			Fluid spillage cc
DNP	BG	ISO	mm				Male MPa	Female MPa	Coupled MPa	
20	3	12.5	10,7	35	45	90	140	160	140	0,012
22	4A	16	12,8	35	74	150	130	130	130	0,015
25	4	19	14,8	35	100	200	130	140	130	0,020
30	5	25	17,6	35	189	280	130	130	130	0,030
35	6	31.5	26	35	288	480	140	130	140	0,040
39	7	40	30	30	379	700	130	120	130	0,050

1 MPa = 145,04 psi • 1 l = 0,264 gal

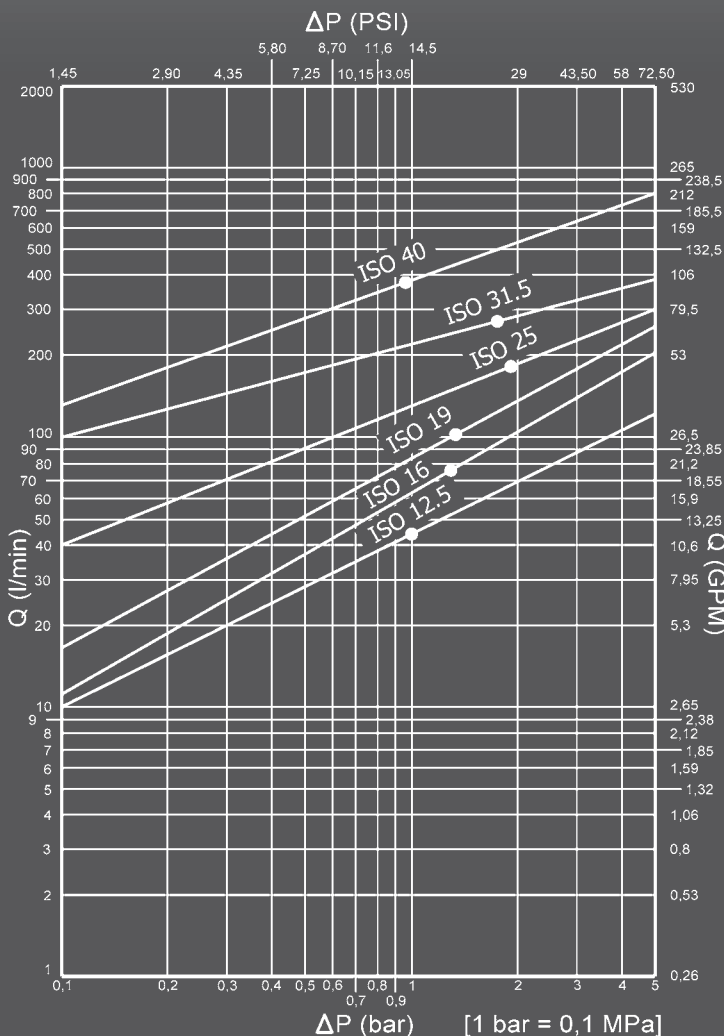

Technical data

- Interchange: exclusive Dnp profile
- Occlusion: flat face
- Locking: screw
- Material: steel
- Finishing: Zn-Fe (Cr III) and Zn-Ni
- Connection: SAE 6000 flanges
- Standard seals: NBR and PU
- Working temperature: -25 °C +100 °C
- Optional seals: FKM, EPDM or more
- Working pressure: 300-350 bar
- Connection under pressure: allowed (both male or female side)
- Max residual pressure: 300 bar

Technische Merkmale

- Austauschbarkeit: laut exklusiver Dnp Zeichnung
- Verschluss: flachdichtend
- Kupplung: Schraubweise
- Werkstoff: Stahl
- Ausführung: Zn-Fe (Cr III) und Zn-Ni
- Anschluss: SAE 6000-Flansche
- Standard-Dichtungen: NBR und PU
- Betriebstemperatur: -25 °C +100 °C
- Dichtungen nach Wahl: FKM, EPDM, usw.
- Betriebsdruck: 300-350 bar
- Kuppeln unter Druck: erlaubt (Steckerseite oder Muffenseite)
- Max. Restdruck: 300 bar

Caracteristiques techniques

- Intercambiabilità: projet exclusif Dnp
- Obturation: clapet plat
- Accrochage: vissé
- Matériel: acier
- Traitement: Zn-Fe (Cr III) et Zn-Ni
- Connexion: SAE 6000 brides
- Joints standard: NBR et PU
- Température de service: -25 °C +100 °C
- Joints facultatifs: FKM, EPDM, ect.
- Pression de service: 300-350 bar
- Connexion sous pression: possible (côté male ou femelle)
- Pression restante max: 300 bar

PVTF DN20 - BG 3 - ISO 12.5

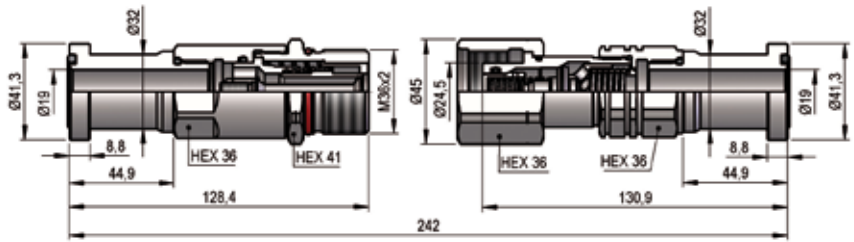

SIZE	STANDARD	FEMMINA - FEMALE - MUFFE - FEMELLE			MASCHIO - MALE - STECKER - MALE		
		COD. F	Weight (g)	Packaging (pcs.)	COD. M	Weight (g)	Packaging (pcs.)
3/4"	SAE J518	PVTF.2027.802	750	15	PVTF.2027.803	720	15

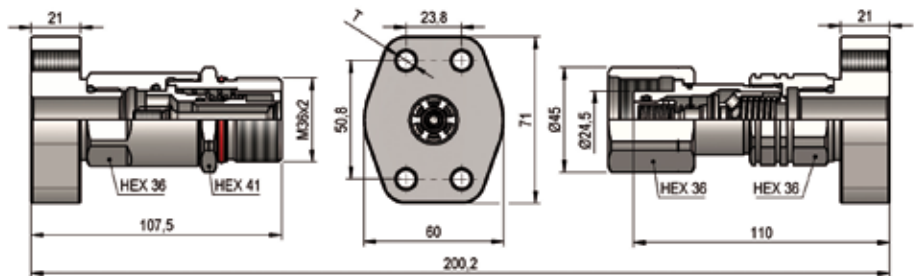

T	SIZE	STANDARD	FEMMINA - FEMALE - MUFFE - FEMELLE			MASCHIO - MALE - STECKER - MALE		
			COD. F	Weight (g)	Packaging (pcs.)	COD. M	Weight (g)	Packaging (pcs.)
M10	3/4"	SAE J518	PVTF.2027.812	1005	10	PVTF.2027.813	970	10
3/8"-16 UNC	3/4"	SAE J518	PVTF.2027.822	1005	10	PVTF.2027.823	970	10

PVTF DN22 - BG 4A - ISO 16

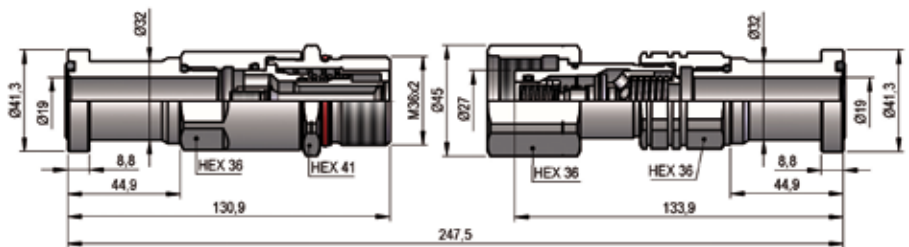

SIZE	STANDARD	FEMMINA - FEMALE - MUFFE - FEMELLE			MASCHIO - MALE - STECKER - MALE		
		COD. F	Weight (g)	Packaging (pcs.)	COD. M	Weight (g)	Packaging (pcs.)
3/4"	SAE J518	PVTF.2227.802	745	15	PVTF.2227.803	730	15

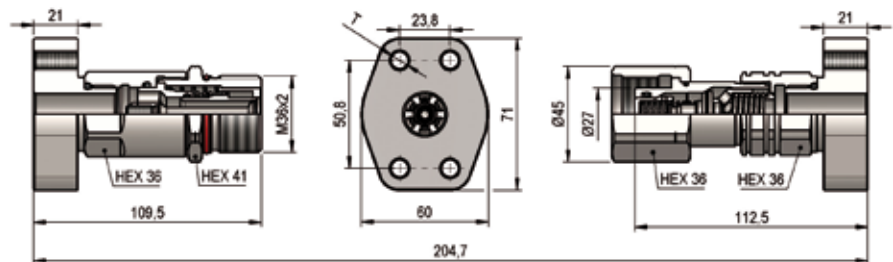

T	SIZE	STANDARD	FEMMINA - FEMALE - MUFFE - FEMELLE			MASCHIO - MALE - STECKER - MALE		
			COD. F	Weight (g)	Packaging (pcs.)	COD. M	Weight (g)	Packaging (pcs.)
M10	3/4"	SAE J518	PVTF.2227.812	995	10	PVTF.2227.813	980	10
3/8"-16 UNC	3/4"	SAE J518	PVTF.2227.822	995	10	PVTF.2227.823	980	10

PVTF DN25 - BG 4 - ISO 19

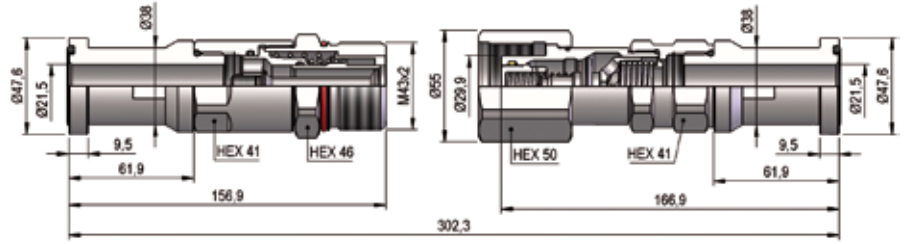

SIZE	STANDARD	FEMMINA - FEMALE - MUFFE - FEMELLE			MASCHIO - MALE - STECKER - MALE		
		COD. F	Weight (g)	Packaging (pcs.)	COD. M	Weight (g)	Packaging (pcs.)
1"	SAE J518	PVTF.2533.802	1210	12	PVTF.2533.803	1200	12

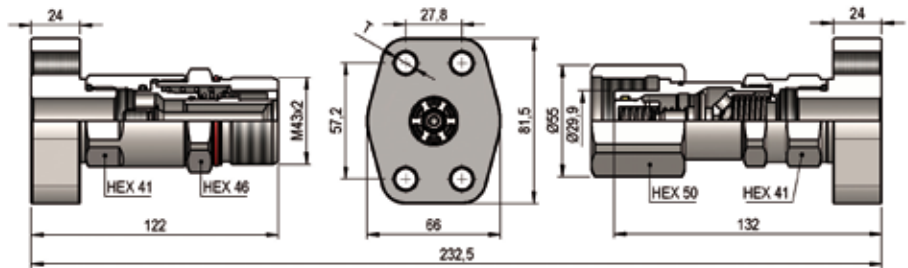

T	SIZE	STANDARD	FEMMINA - FEMALE - MUFFE - FEMELLE			MASCHIO - MALE - STECKER - MALE		
			COD. F	Weight (g)	Packaging (pcs.)	COD. M	Weight (g)	Packaging (pcs.)
M12	1"	SAE J518	PVTF.2533.812	1490	8	PVTF.2533.813	1480	8
7/16"-14 UNC	1"	SAE J518	PVTF.2533.822	1490	8	PVTF.2533.823	1480	8

PVTF DN30 - BG 5 - ISO 25

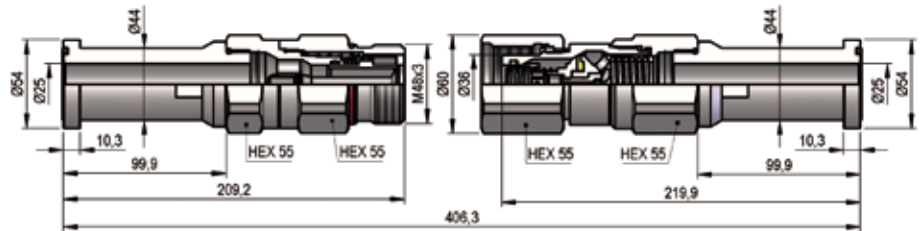

SIZE	STANDARD	FEMMINA - FEMALE - MUFFE - FEMELLE			MASCHIO - MALE - STECKER - MALE		
		COD. F	Weight (g)	Packaging (pcs.)	COD. M	Weight (g)	Packaging (pcs.)
1 1/4"	SAE J518	PVTF.3041.802	2250	8	PVTF.3041.803	2440	6

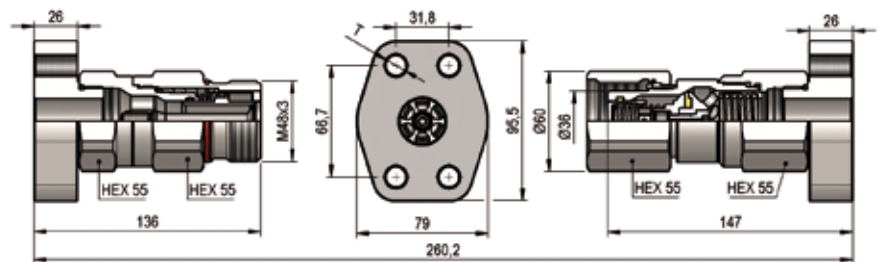

T	SIZE	STANDARD	FEMMINA - FEMALE - MUFFE - FEMELLE			MASCHIO - MALE - STECKER - MALE		
			COD. F	Weight (g)	Packaging (pcs.)	COD. M	Weight (g)	Packaging (pcs.)
M14	1 1/4"	SAE J518	PVTF.3041.812	2390	5	PVTF.3041.813	2575	5
1/2"-13 UNC	1 1/4"	SAE J518	PVTF.3041.822	2390	5	PVTF.3041.823	2575	5

PVTF DN35 - BG 6 - ISO 31.5

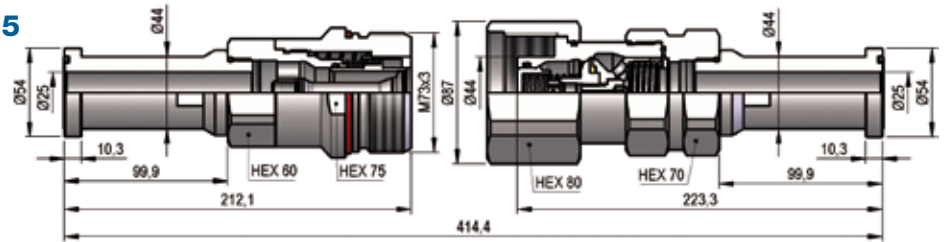

SIZE	STANDARD	FEMMINA - FEMALE - MUFFE - FEMELLE			MASCIO - MALE - STECKER - MALE		
		COD. F	Weight (g)	Packaging (pcs.)	COD. M	Weight (g)	Packaging (pcs.)
1"¼	SAE J518	PVTF.3541.802	3310	4	PVTF.3541.803	3900	4

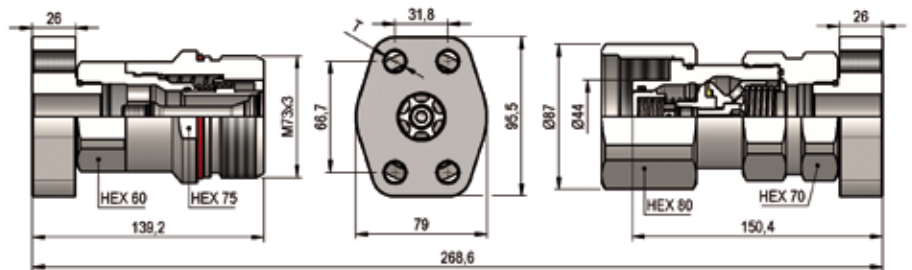

T	SIZE	STANDARD	FEMMINA - FEMALE - MUFFE - FEMELLE			MASCIO - MALE - STECKER - MALE		
			COD. F	Weight (g)	Packaging (pcs.)	COD. M	Weight (g)	Packaging (pcs.)
M14	1"¼	SAE J518	PVTF.3541.812	3445	3	PVTF.3541.813	4035	3
	1/2"-13 UNC	SAE J518	PVTF.3541.822	3445	3	PVTF.3541.823	4035	3

PVTF DN39 - BG 7 - ISO 40

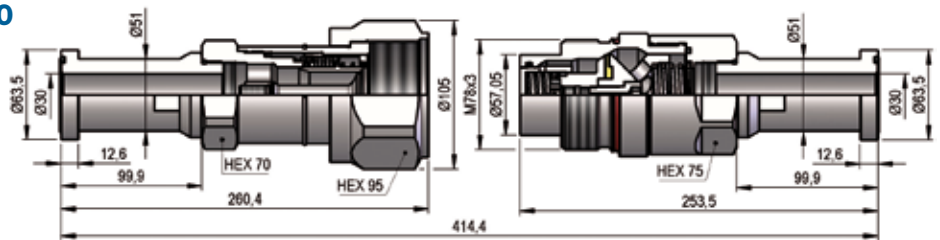

SIZE	STANDARD	FEMMINA - FEMALE - MUFFE - FEMELLE			MASCIO - MALE - STECKER - MALE		
		COD. F	Weight (g)	Packaging (pcs.)	COD. M	Weight (g)	Packaging (pcs.)
1"½	SAE J518	PVTF.3947.802	5160	2	PVTF.3947.803	5090	2

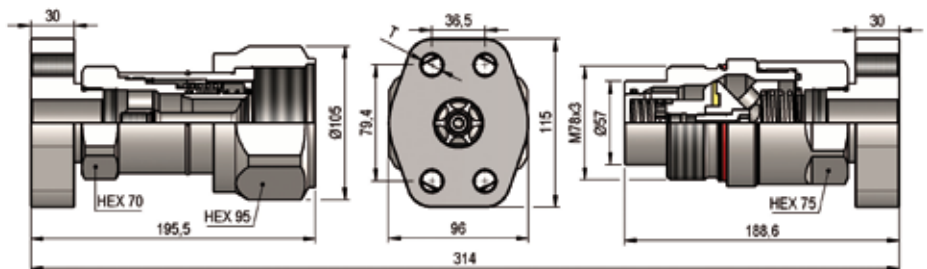

T	SIZE	STANDARD	FEMMINA - FEMALE - MUFFE - FEMELLE			MASCIO - MALE - STECKER - MALE		
			COD. F	Weight (g)	Packaging (pcs.)	COD. M	Weight (g)	Packaging (pcs.)
M16	1"½	SAE J518	PVTF.3947.812	5550	1	PVTF.3947.813	5470	1
	5/8"-11 UNC	SAE J518	PVTF.3947.822	5550	1	PVTF.3947.823	5470	1

PLASTIC CAPS

NOMINAL SIZE			FEMALE DUST PLUG					MALE DUST CAP					COLOUR	MATERIAL
DNP	BG	ISO	Dimensions			Weight	Dimensions			Weight				
			COD. F	D	L	D1	(g)	COD. M	D	L	D1	(g)		
20	3	12.5	SPVT.20002	45	220	32	48	SPVT.20003	45	220	32	48	●	PVC
22	4A	16	SPVT.20002	45	220	32	48	SPVT.20003	45	220	32	48	●	PVC
25	4	19	SPVT.25002	53	290	47,5	72	SPVT.25003	48	290	47,5	74	●	PVC
30	5	25	SPVT.30002	60	438	47,5	94	SPVT.30003	60	438	47,5	91	●	PVC

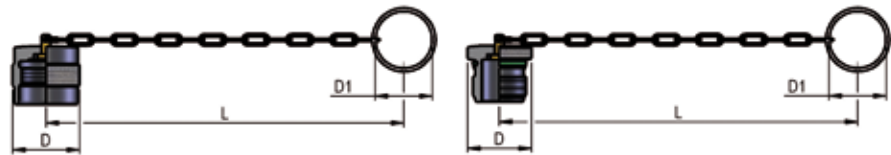
METAL CAPS

NOMINAL SIZE			FEMALE DUST PLUG					MALE DUST CAP					MATERIAL
DNP	BG	ISO	Dimensions			Weight	Dimensions			Weight			
			COD. F	D	L	D1	(g)	COD. M	D	L	D1	(g)	
20	3	12.5	SPVV.13202	41,5	205	32	57	SPVV.13203	41,5	205	32	66	Aluminum
22	4A	16	SPVV.13202	41,5	205	32	57	SPVV.13203	41,5	205	32	66	Aluminum
25	4	19	SPVT.25202	49,5	275	47,5	84	SPVT.25203	48	275	47,5	115	Aluminum
30	5	25	SPVT.30202	54,5	275	47,5	91	SPVT.30203	58	275	47,5	113	Aluminum
35	6	31.5	SPVT.35202	79,5	275	47,5	179	SPVT.35203	87	275	47,5	353	Aluminum
39	7	40	SPVT.39202	90	275	47,5	269	SPVT.39203	90	275	47,5	380	Aluminum

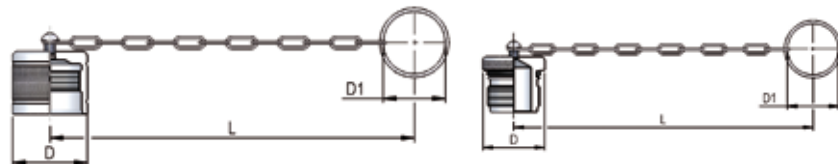
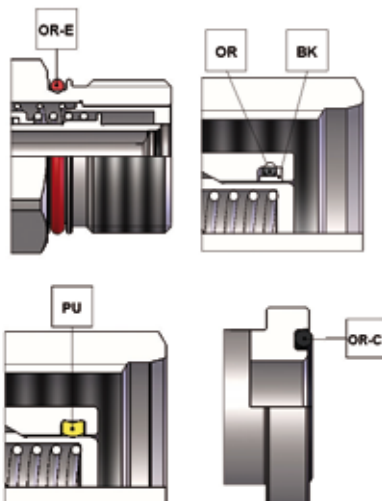
SPARE PARTS

NOMINAL SIZE			FEMALE GASKET	MALE GASKET	MALE GASKET	FLANGE GASKET	
DNP	BG	ISO	OR-E (SILICONE)	OR (NBR*)	BK (PTFE)	PU (POLYURETHANE)	OR-C (NBR*)
20	3	12.5	PVT.019.121 S	PLT.019.120	PLT.019.130	PVT.019.210	SAE.020.120
22	4A	16	PVT.019.121 S	PLT.022.120	PLT.022.130	PVT.022.210	SAE.020.120
25	4	19	PVT.025.121 S	PLT.025.120	PLT.025.130	PVT.025.210	PGR.025.120
30	5	25	PVT.030.121 S	PLT.031.120	PLT.031.130	PVT.030.210	PBV.025.120
35	6	31.5	PVT.035.121 S	PLS.025.120	PLT.035.130	-	PBV.025.120
39	7	40	PVT.039.121 S	PLT.039.120	PLT.039.130	-	SAE.039.120

* AL CODICE DELLA GUARNIZIONE IN NBR AGGIUNGERE 'E' PER EPDM O 'V' PER VITON
 TO THE NBR GASKET CODE ADD 'E' FOR EPDM OR 'V' FOR VITON
 ZU DER ARTIKELNR. DER NBR DICHTUNG GEBEN SIE 'E' FUER EPDM ODER 'V' FUER VITON AN
 AU CODE DU JOINT EN NBR JOINDRE 'E' POUR EPDM OU 'V' POUR VITON